

# GENERAL PLAN

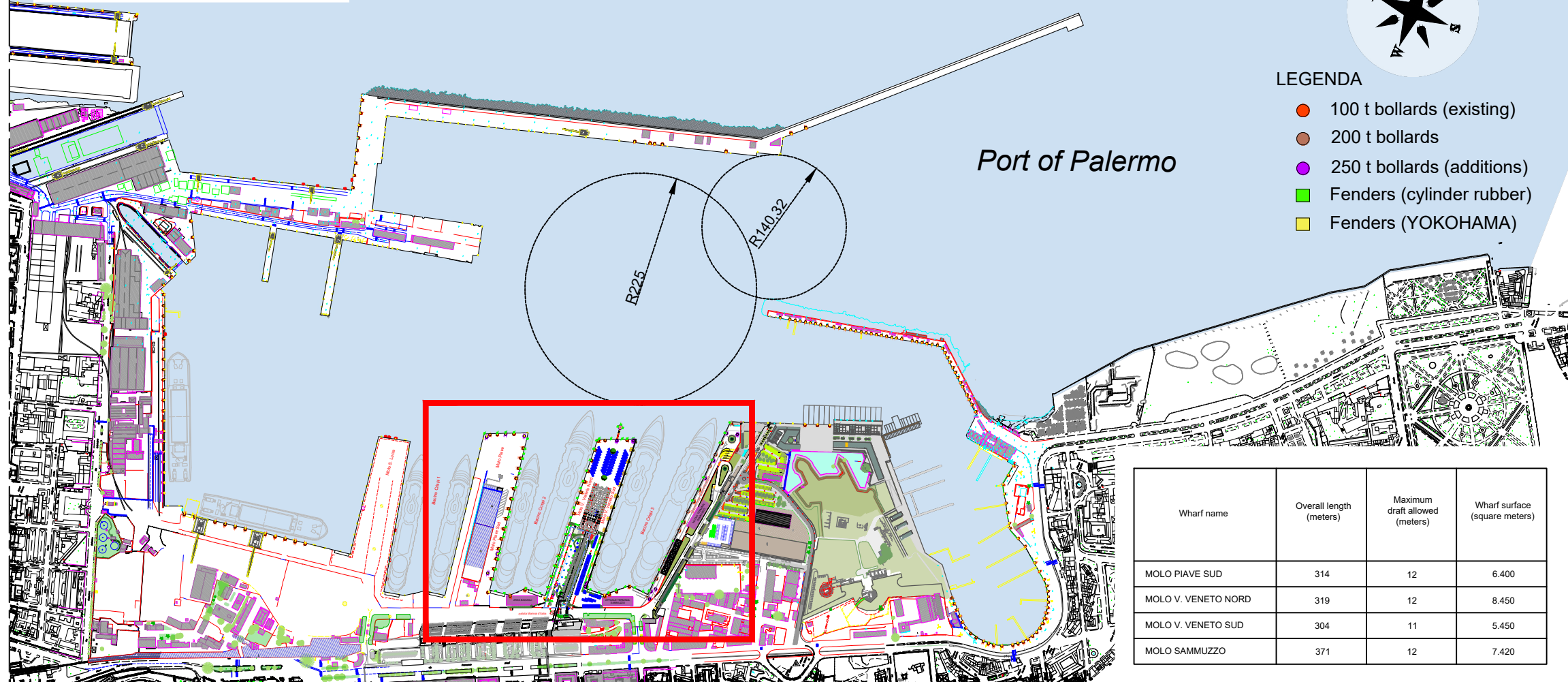

- LEGENDA**
- 100 t bollards (existing)
  - 200 t bollards
  - 250 t bollards (additions)
  - Fenders (cylinder rubber)
  - Fenders (YOKOHAMA)

Wharf name	Overall length (meters)	Maximum draft allowed (meters)	Wharf surface (square meters)
MOLO PIAVE SUD	314	12	6.400
MOLO V. VENETO NORD	319	12	8.450
MOLO V. VENETO SUD	304	11	5.450
MOLO SAMMUZZO	371	12	7.420

# DETAILED PLAN

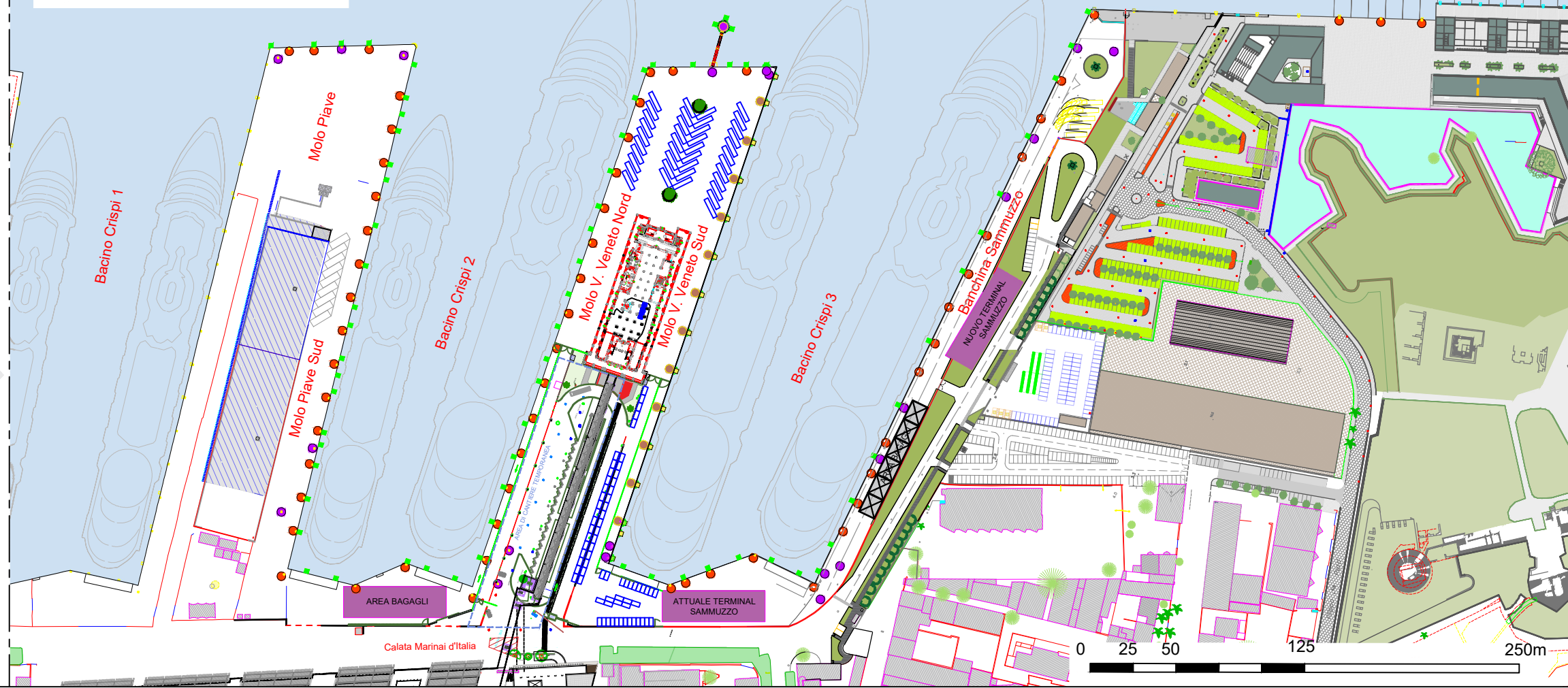

## KEY - PLAN



## GENERAL INFORMATION

**PILOTING**  
 VHF CH.: 12  
 TELEPHONE: +39 091586829  
 SERVICE HOURS: 24 hours a day  
 PILOT STATION POSITION: 38°08'N/13°24'E  
 DISTANCE BETWEEN P.S. AND MOORING: 2 mg  
 TIME BETWEEN P.S. AND MOORING: about 15 min/7 knots  
 E.T.A. RESTRICTIONS / E.T.D.: NO  
 PREVAILING WINDS: SE/SW  
 PILOT BOAT FREE EDGE: 1,2 mt

**ROTATION BASIN**  
 MINIMUM DRAFT: 16 mt  
 DIAMETER: 400/450 meters

**ACCESS CHANNEL DIMENSIONS**  
 MINIMUM DRAFT: 15 mt  
 MINIMUM WIDTH: 280 mt

**MAXIMUM SHIP SIZE ALLOWED**  
 DRAFT: 12 mt  
 L.O.A.: 380 mt  
 WIDTH: 45 mt  
 AIR DRAFT: NO LIMITS

**LARGEST CRUISE SHIP MOORED**  
 NAME: Odyssey of the Seas  
 L.O.A.: 347 mt  
 DRAFT: 8,8 mt

**TRAILER**  
 N. OF TUGS AVAILABLE: 1 tugs da 5.500 Hp / 55 tons pulling from 06,00 to 19,00  
 ADDITIONAL TOW: on request by 3:00 pm the previous day

**ANCHOR AREAS**

- 1: 38°06',5" N/13°24' E
- 2: 238°07' N/13°24',3 E
- 3: 38°09',2 N/13°24',2 E
- 4: 13°08',4 N/13°23',2 E
- 5: 38°07' N/13°26' E
- 6: 38°06',6 N/13°28',4 E

MINIMUM DRAFT: 50 mt  
 BOTTOM TYPE: MUD / SAND

**PORT SECURITY INFORMATION**  
 PFSO NAME: CORRAO ANTONINO  
 PFSO CONTACT: [329 0215368](tel:3290215368) - [antonino.corrao@wsgct.com](mailto:antonino.corrao@wsgct.com)

PORTO DI PALERMO

